

9ft & 10ft Wagon Kits

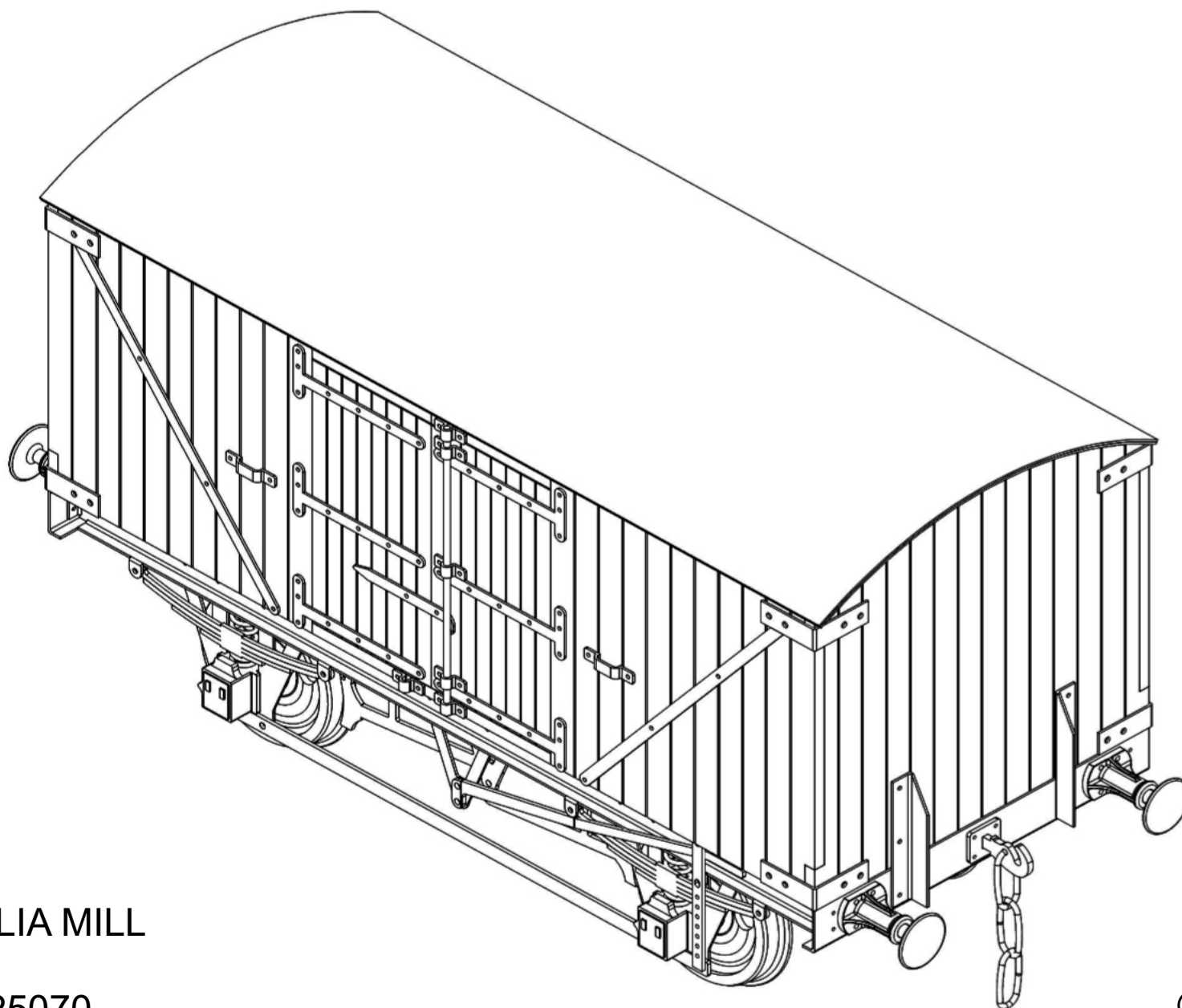

17D LTD
UNIT 13
VIA GELLIA MILL
DE4 2AJ
01629 825070

©17D LTD

Wagon Chassis

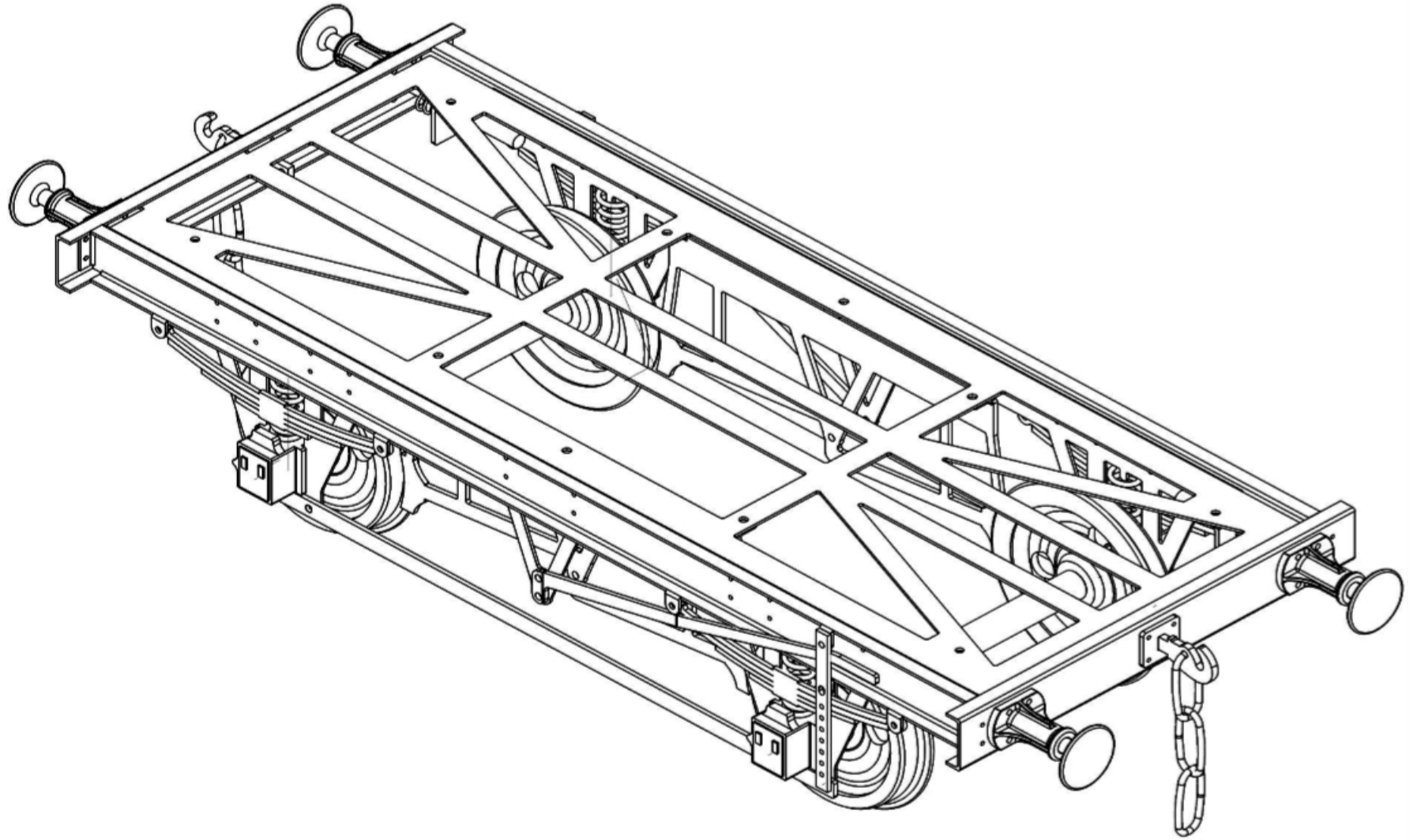

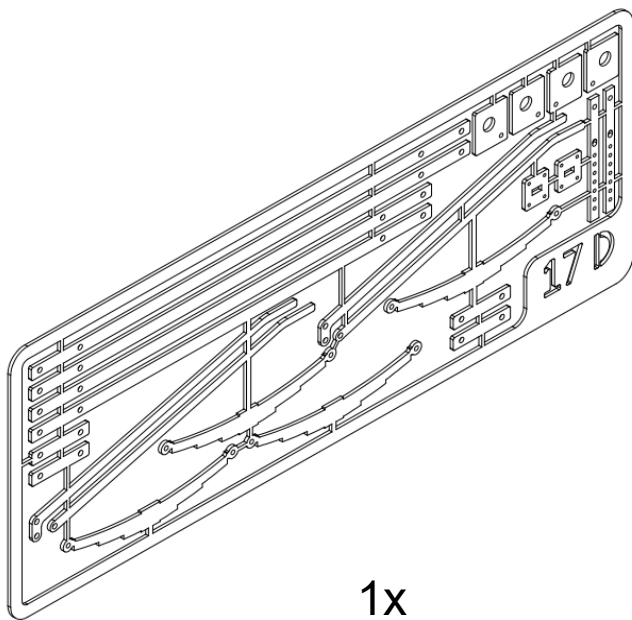

1x
9ft and 10ft Fret

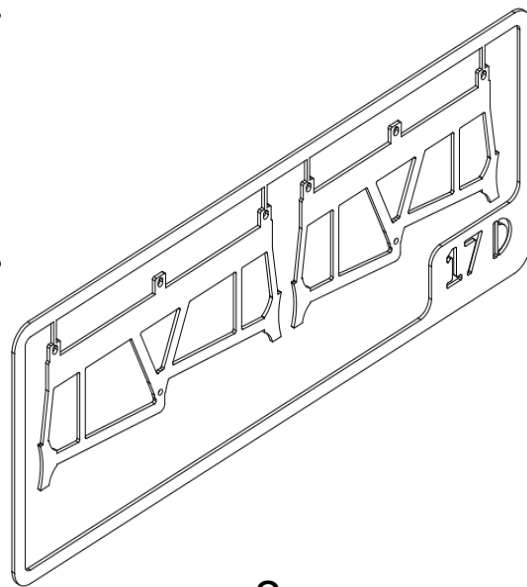

2x
Dummy Brake Fret

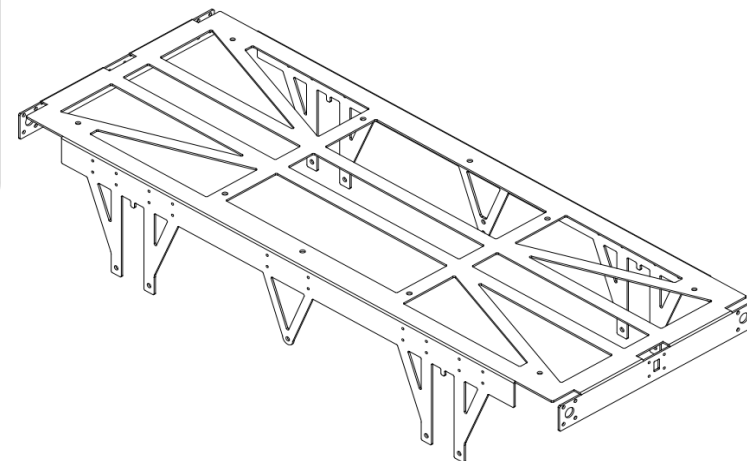

1x
Pre Folded Frame



2x
Buffer Beam

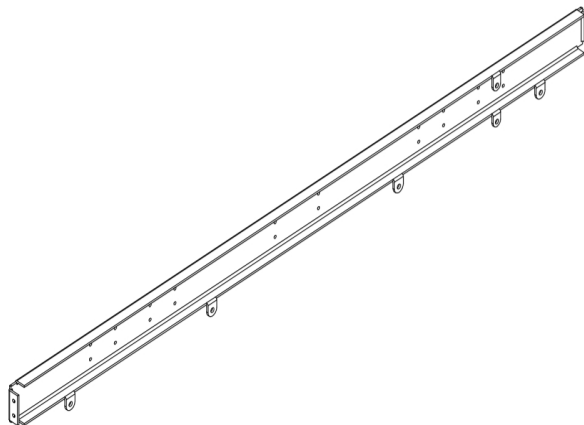

2x
Side Frames

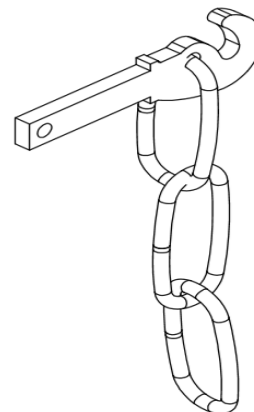

2x
Hook on Chain

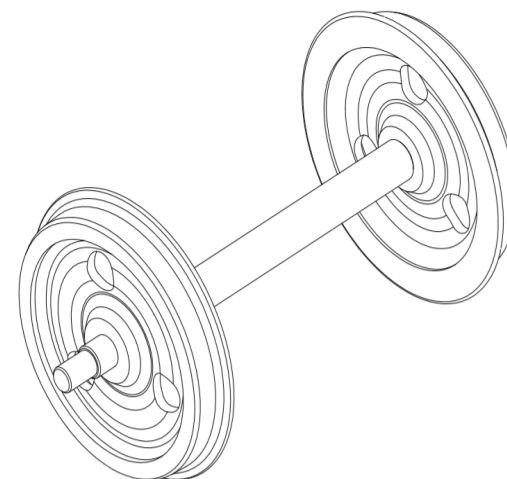

2x
Wheel on Axle

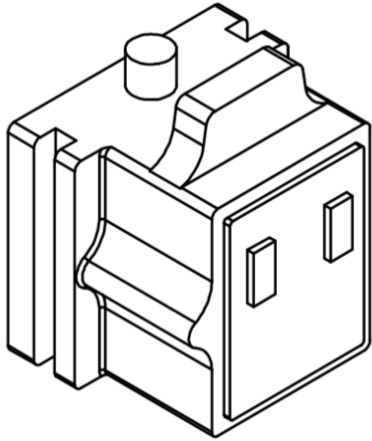

4x
Axle box

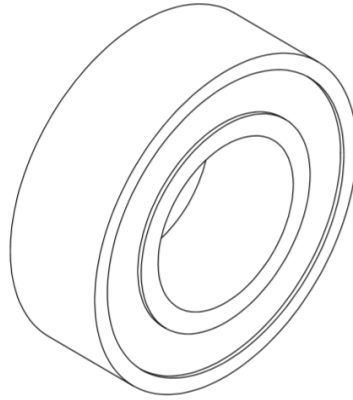

4x
Bearings

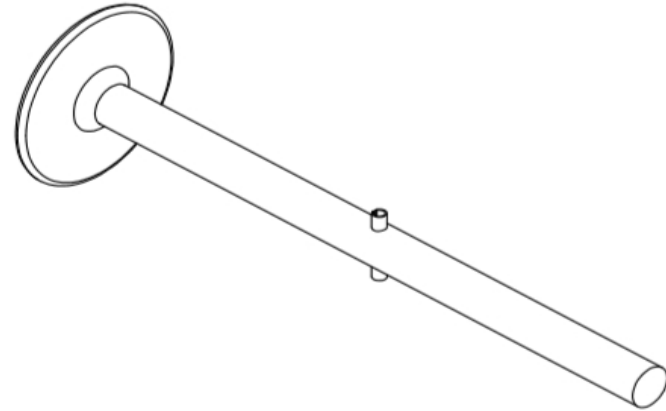

4x
RCH Buffer Heads + Pins

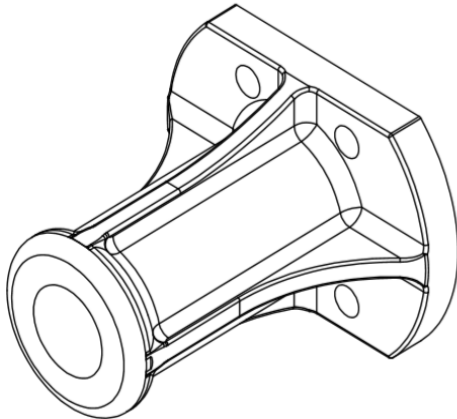

4x
RCH Buffer Stock

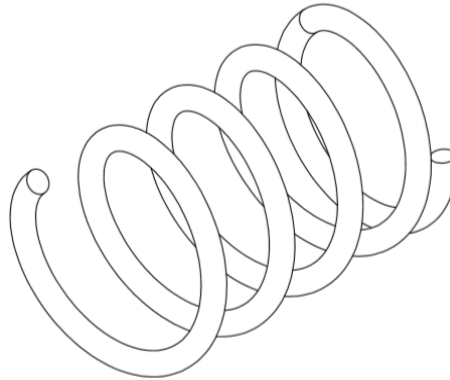

4x
RCH Buffer Springs

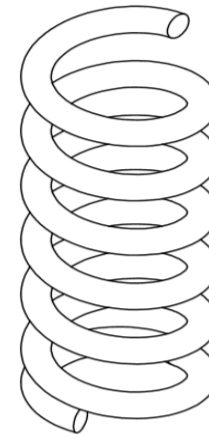

4x
Suspension Spring

Cut out required parts:

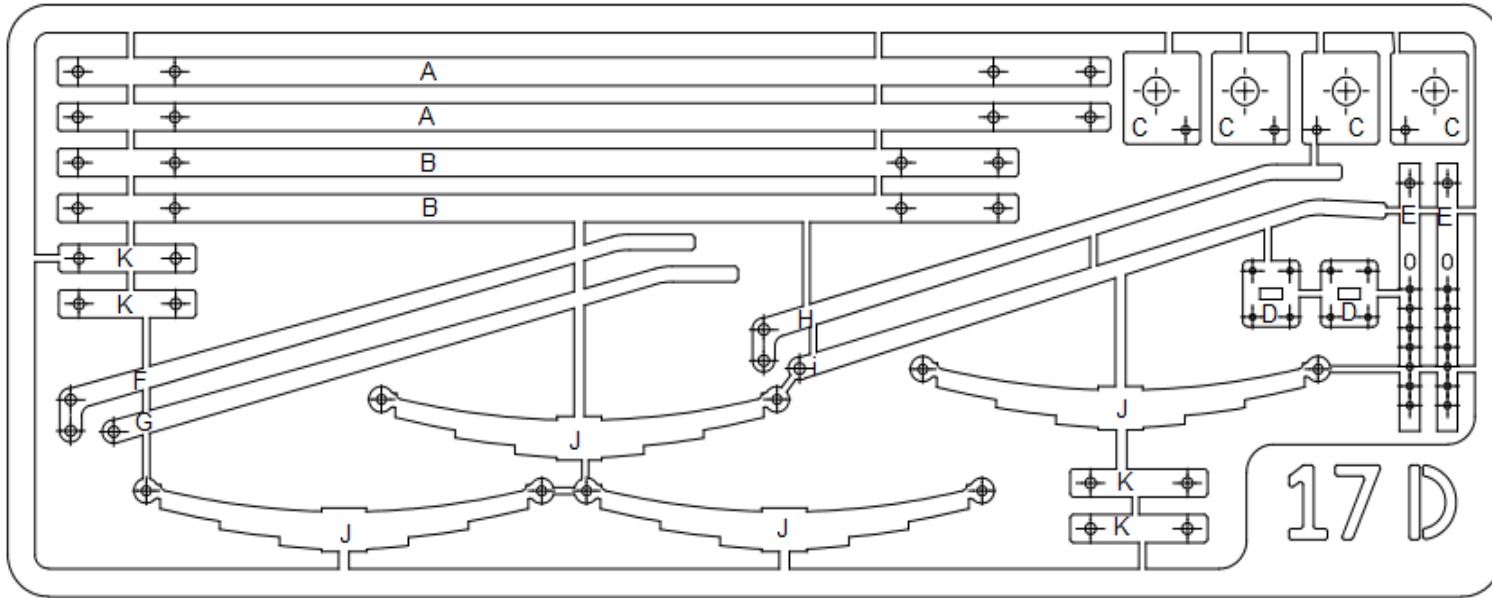

A = 10ft only
B = 9ft only
C = Required
D = Required
E = Required
F = 9ft only
G = 9ft only
H = 10ft only
I = 10ft only
J = Required
K = Choice

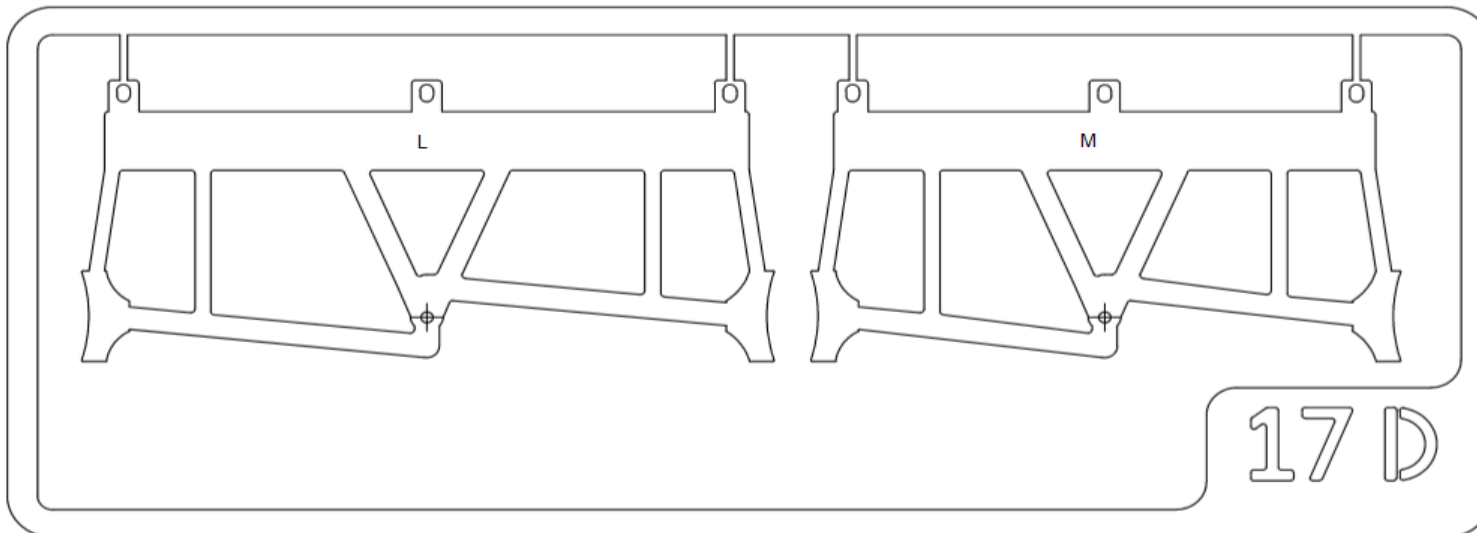

L = 10ft only
M = 9ft only

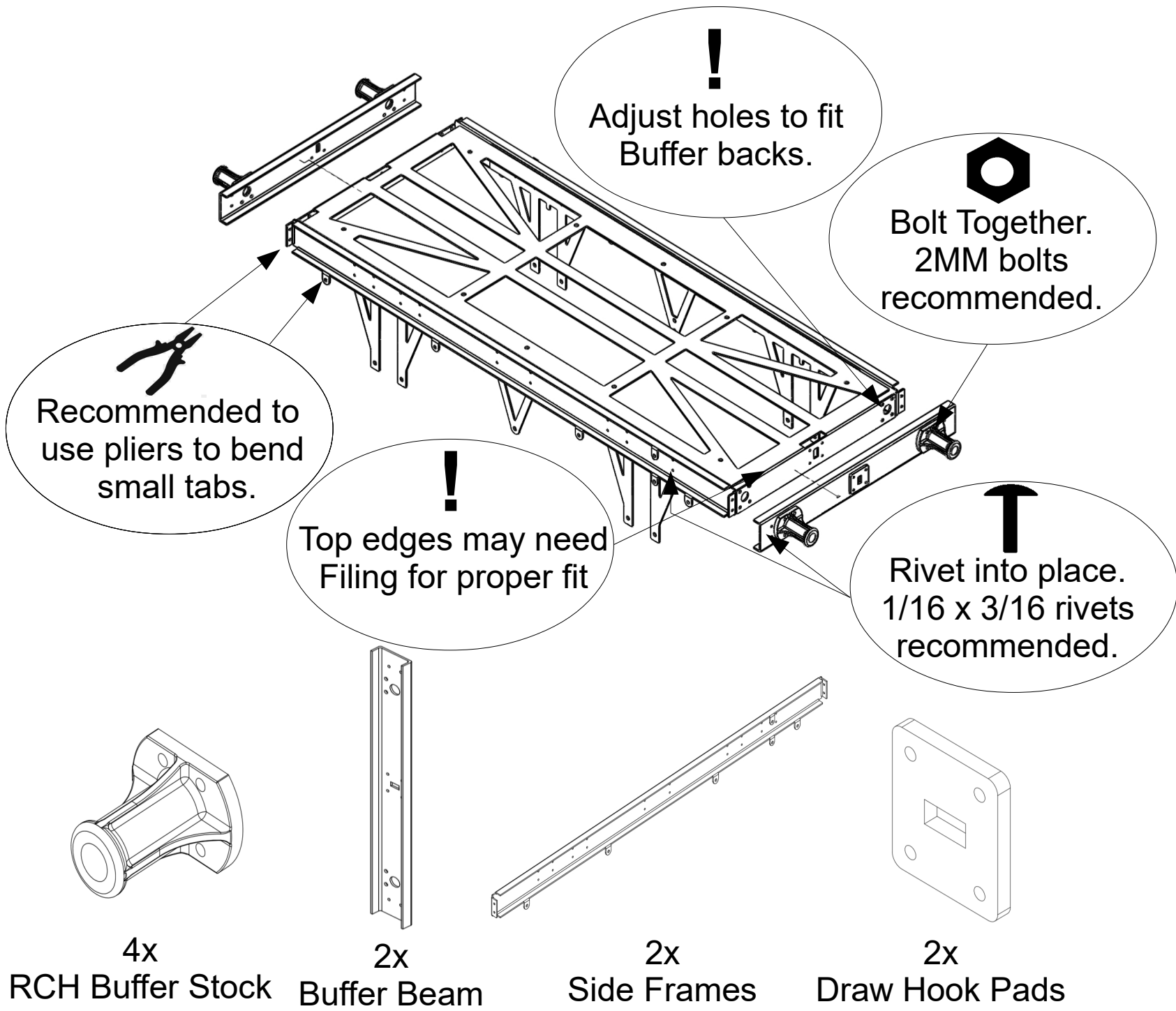

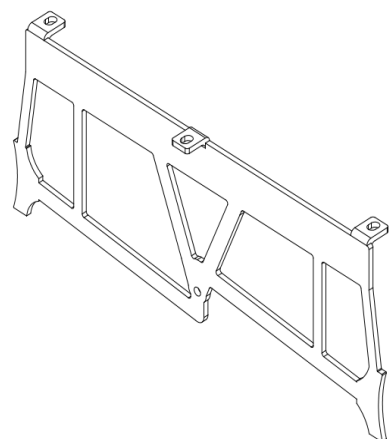
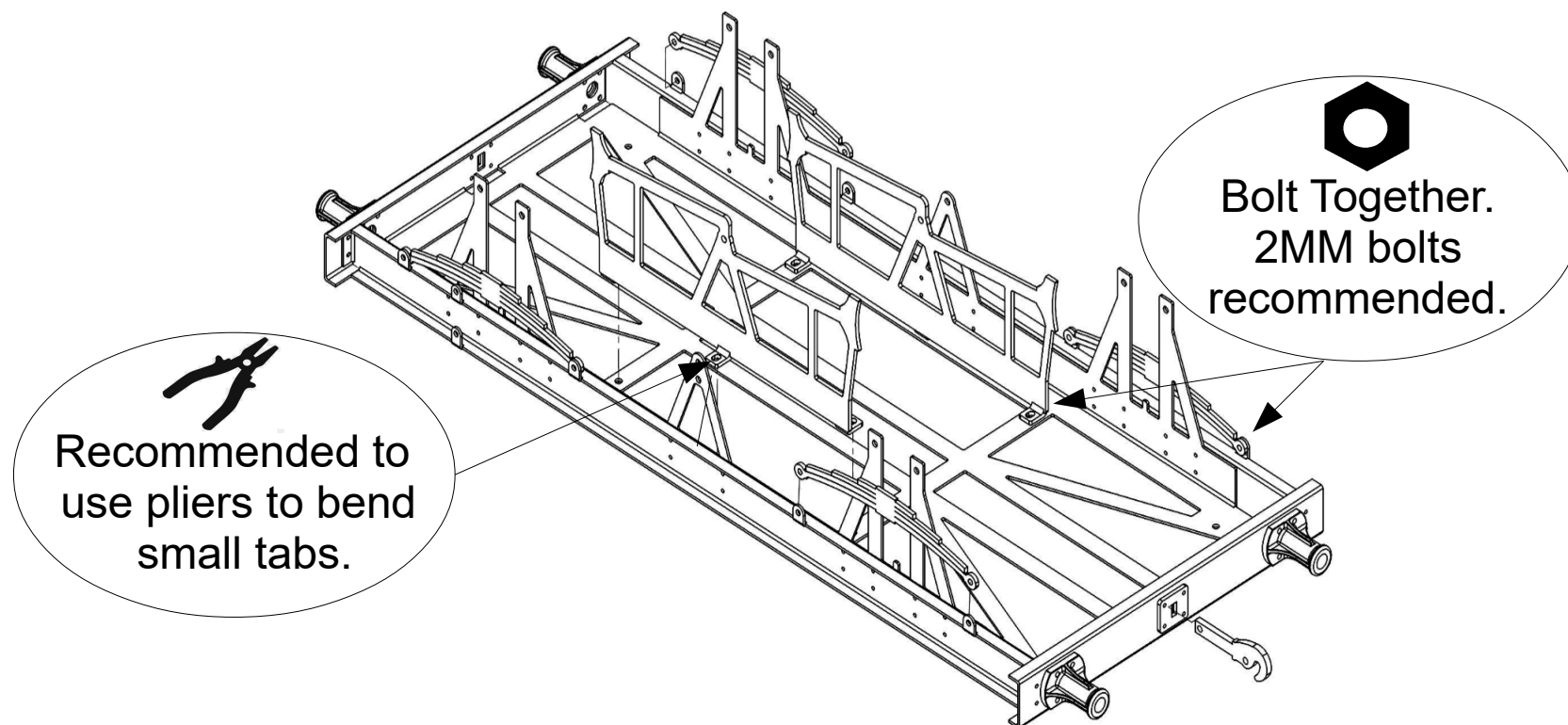

2x
Dummy Brake Fret

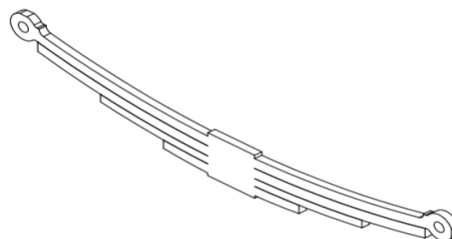

4x
Leaf Spring

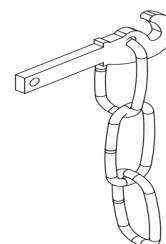

2x
Hook on Chain

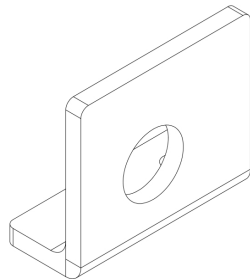
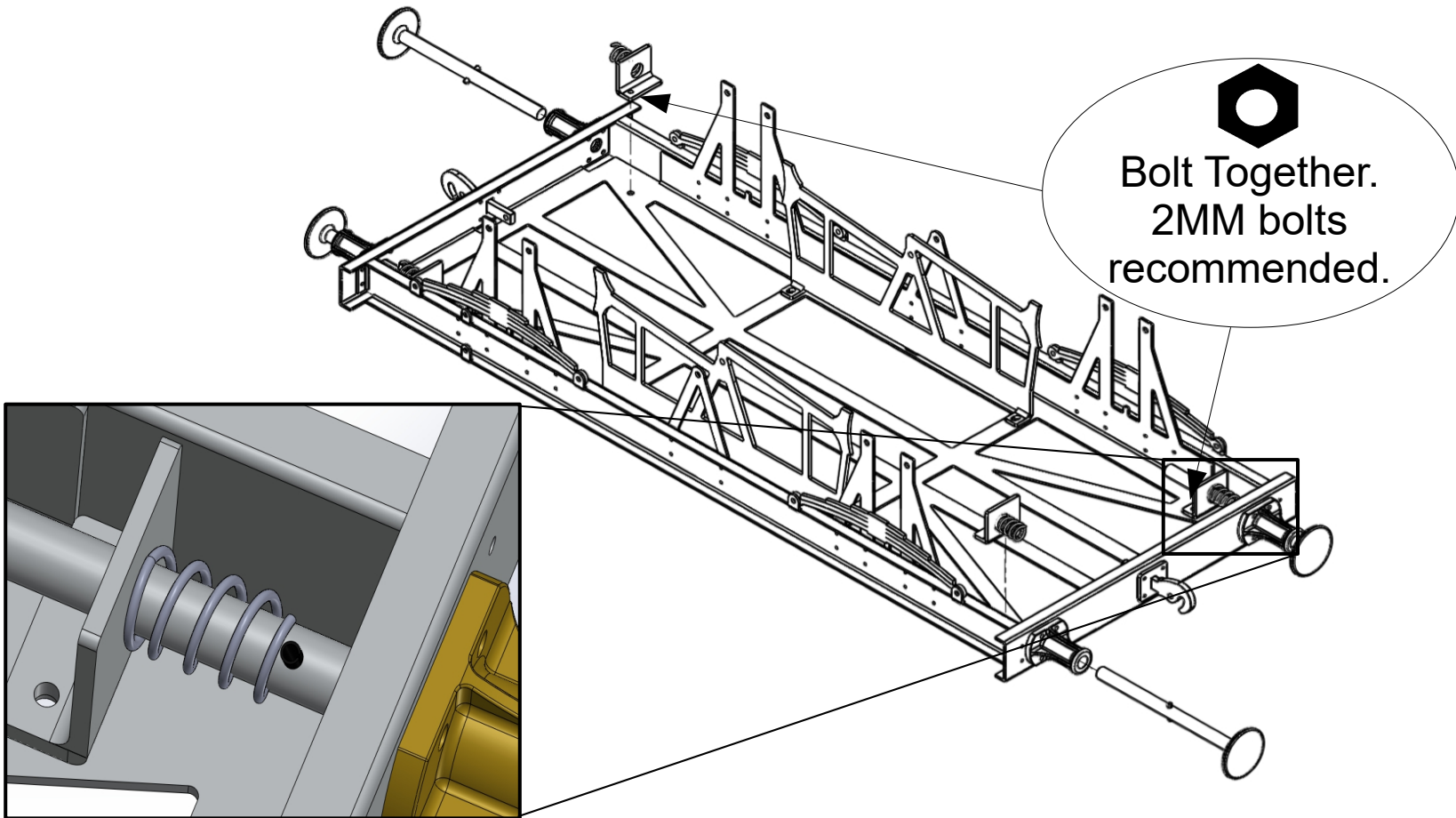

4x
Folded Buffer Keep

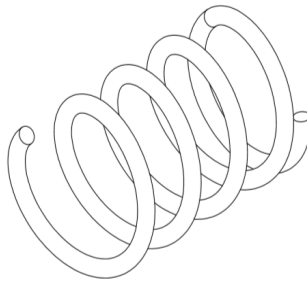

4x
RCH Buffer Springs

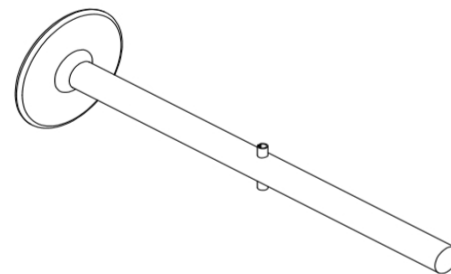

4x
RCH Buffer Heads + Pins

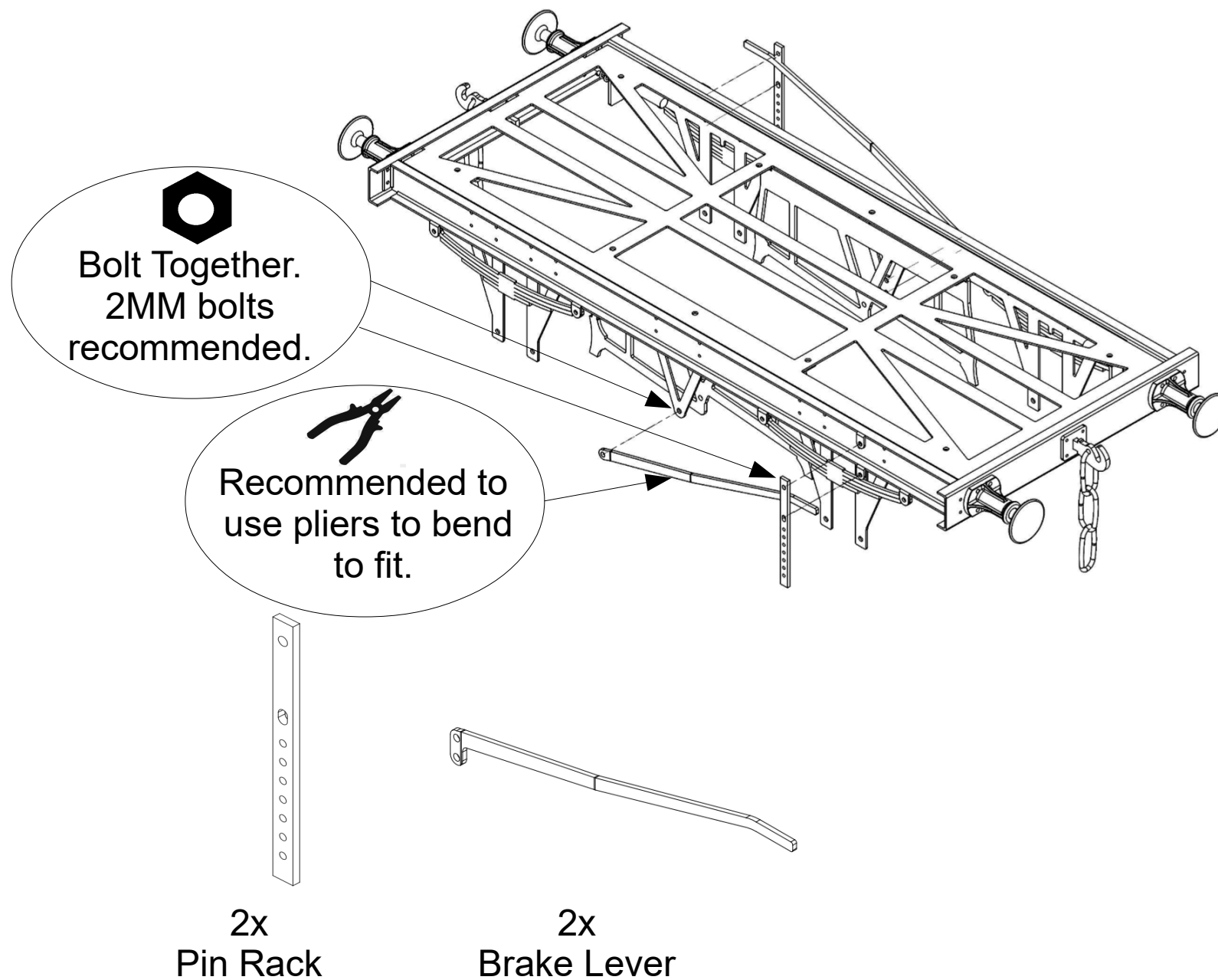

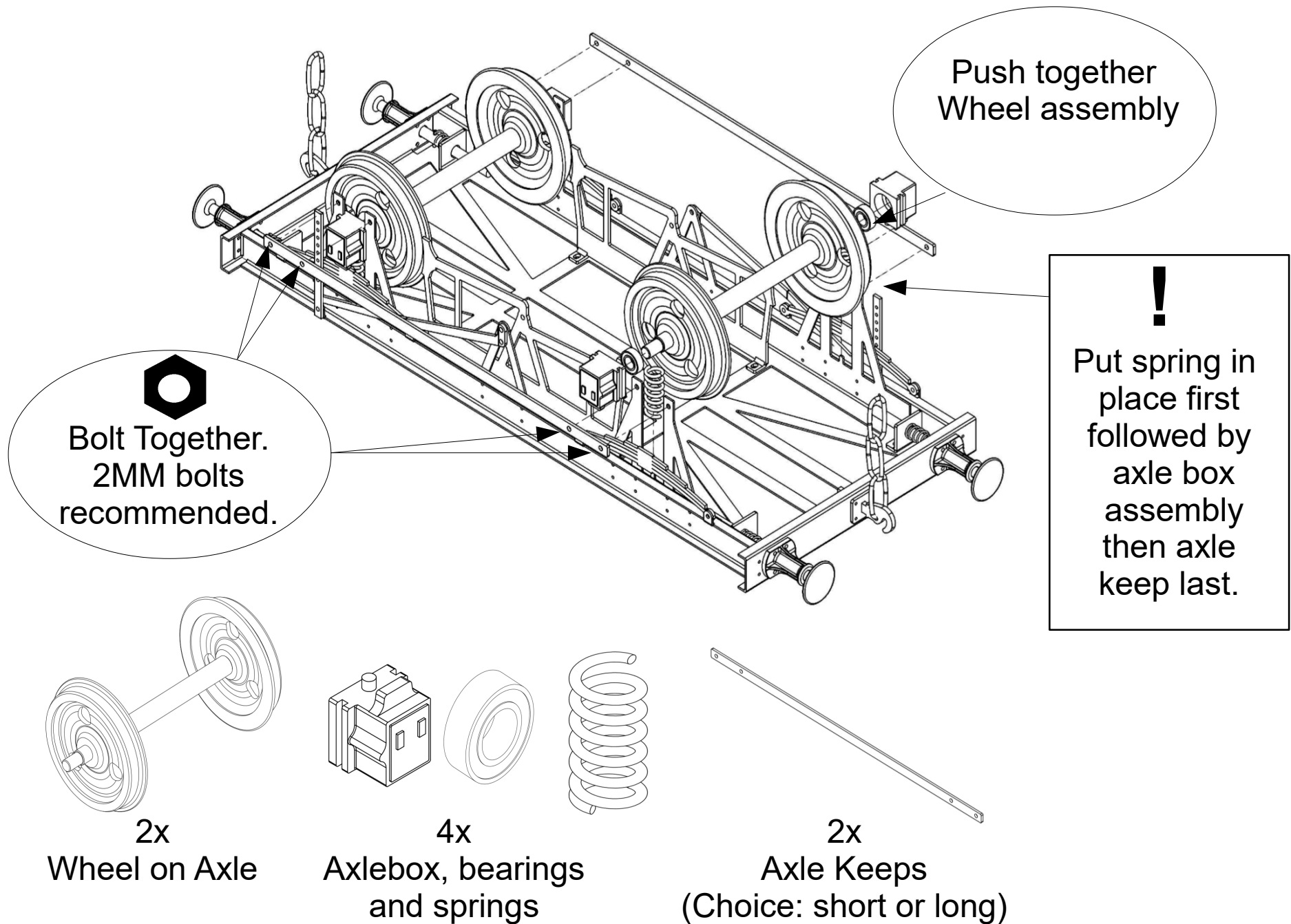

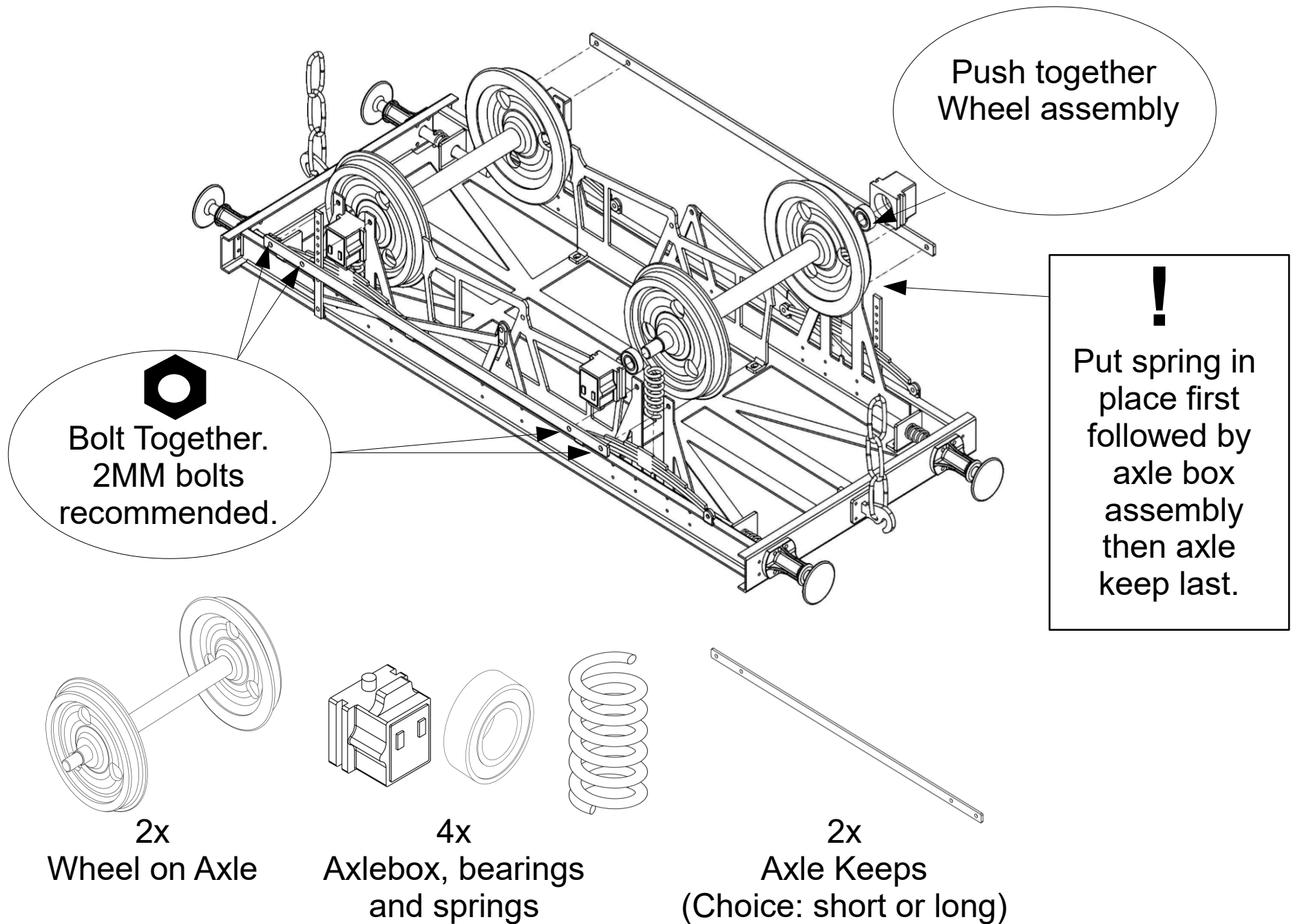

Planked Wagon Kit

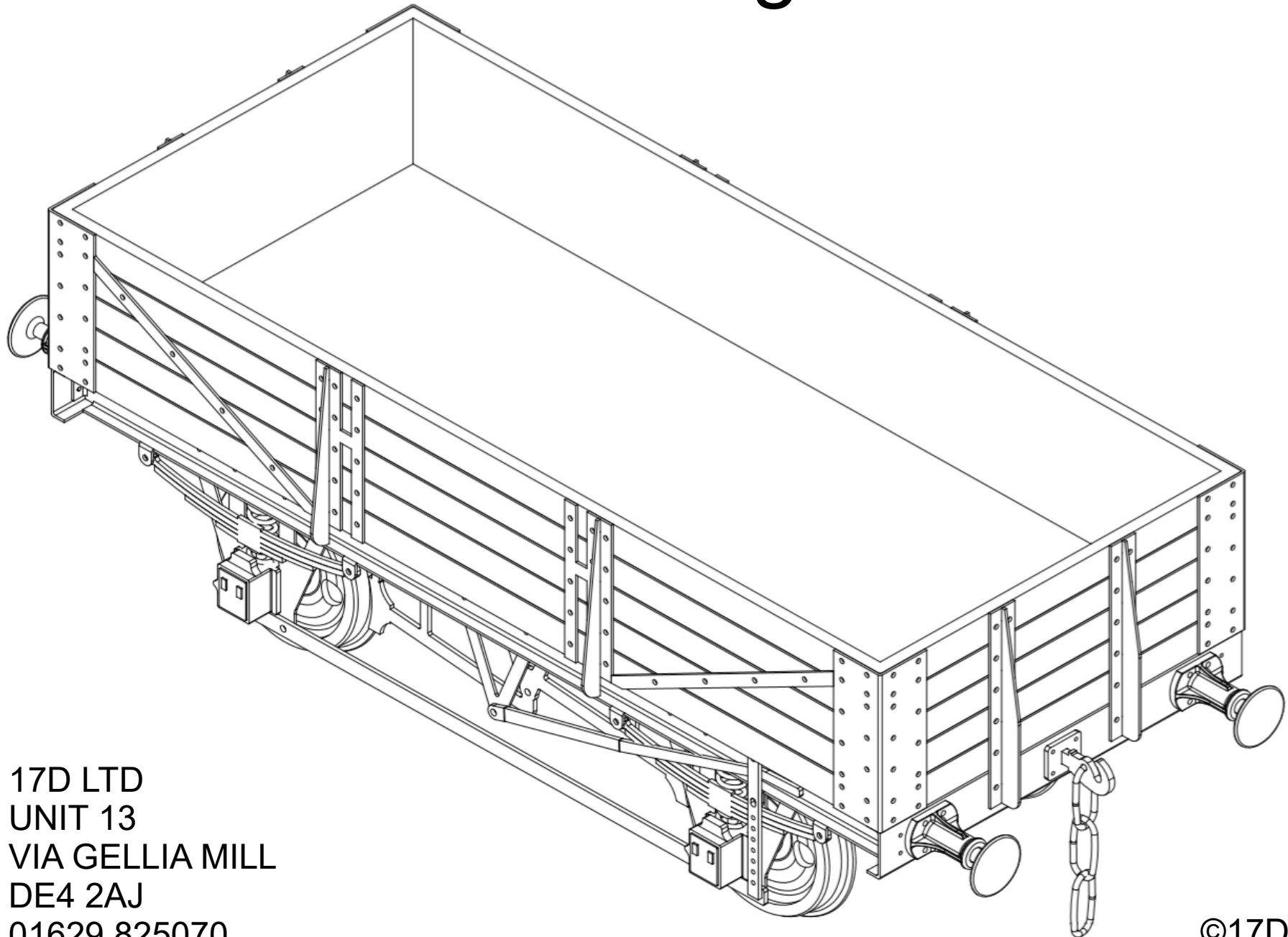

17D LTD
UNIT 13
VIA GELLIA MILL
DE4 2AJ
01629 825070

©17D LTD

Planked Versions:

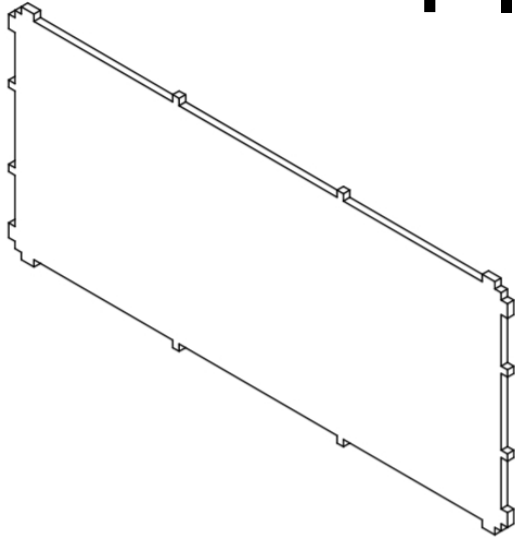

1x
Wooden Base

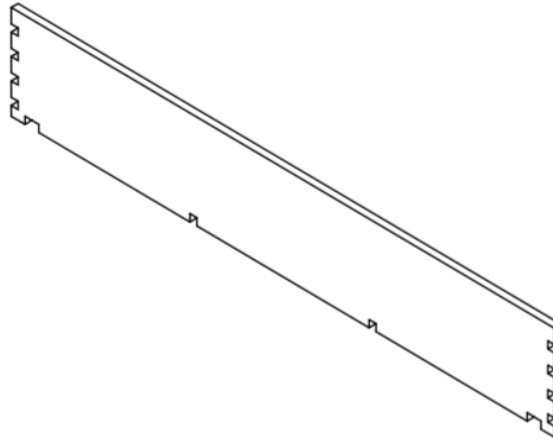

2x
Wooden Sides

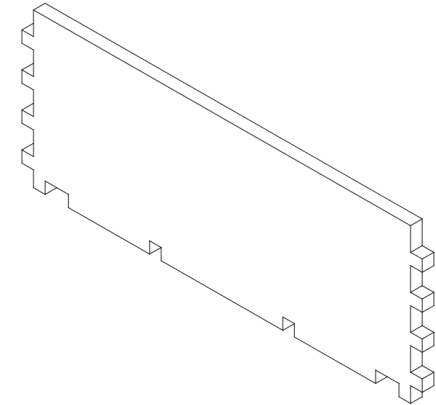

2x
Wooden Front and back

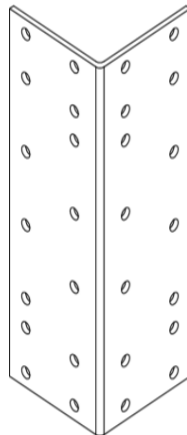

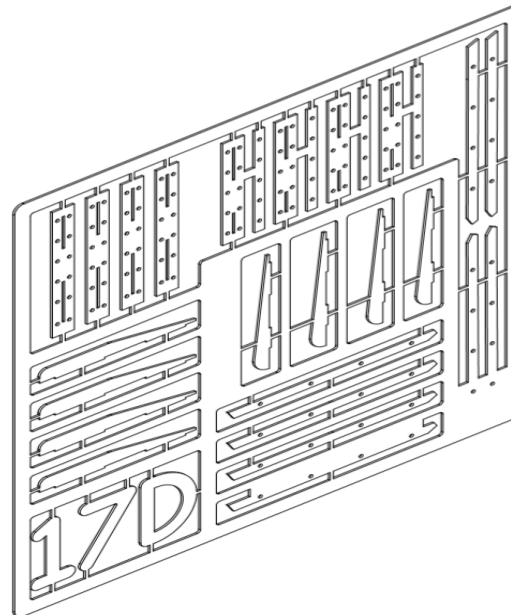

4x
Strapping Folded Corner:
5 Plank or 7 Plank

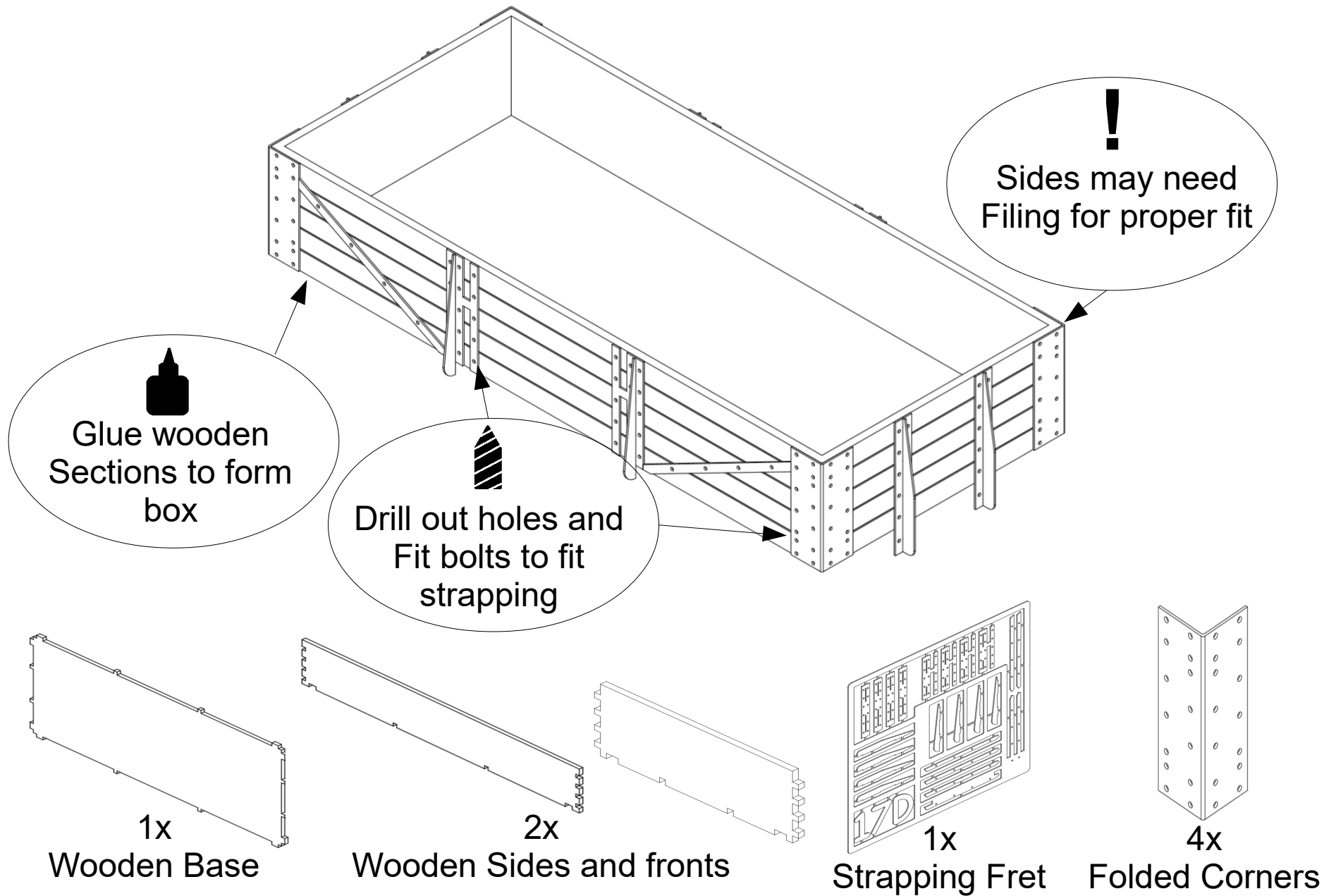

1x
Strapping Fret:
5 Plank or 7 Plank

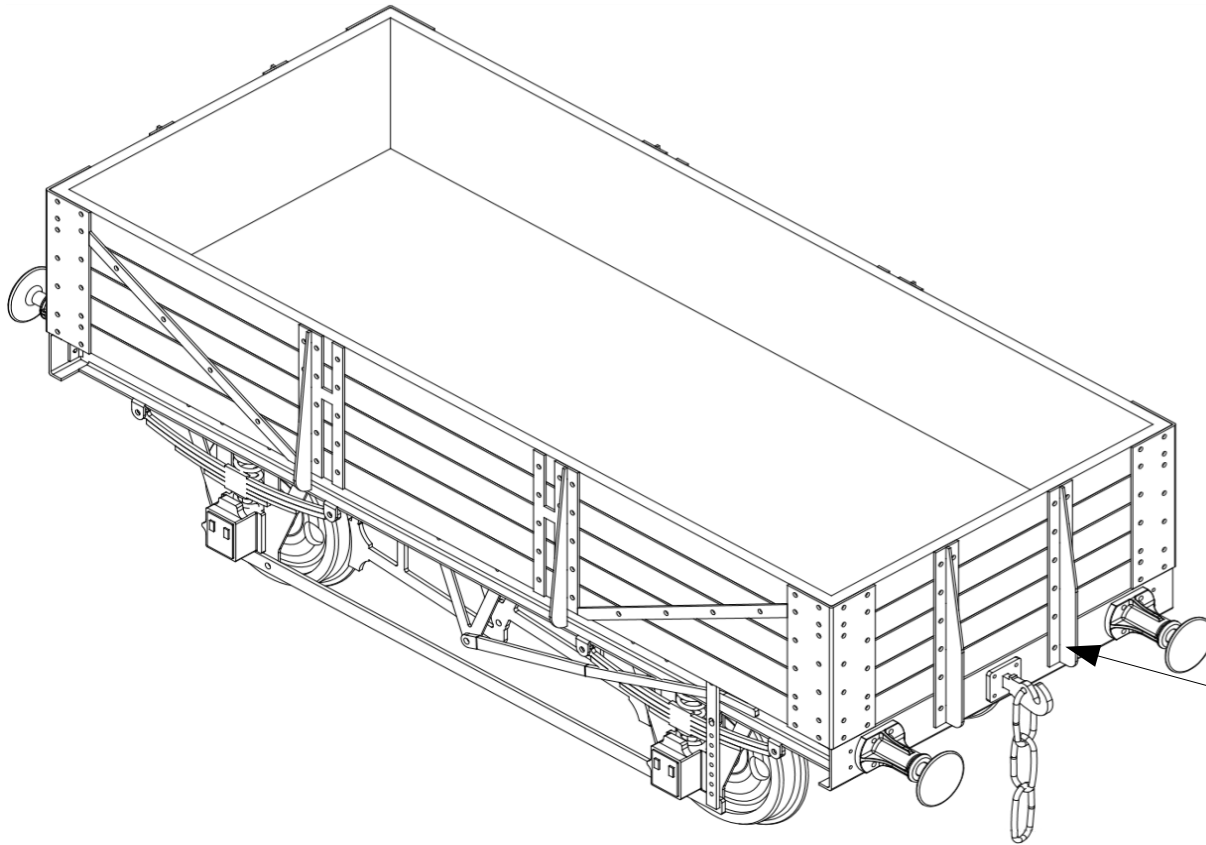





Drill out holes and
Fit bolts to
assemble

And Enjoy!

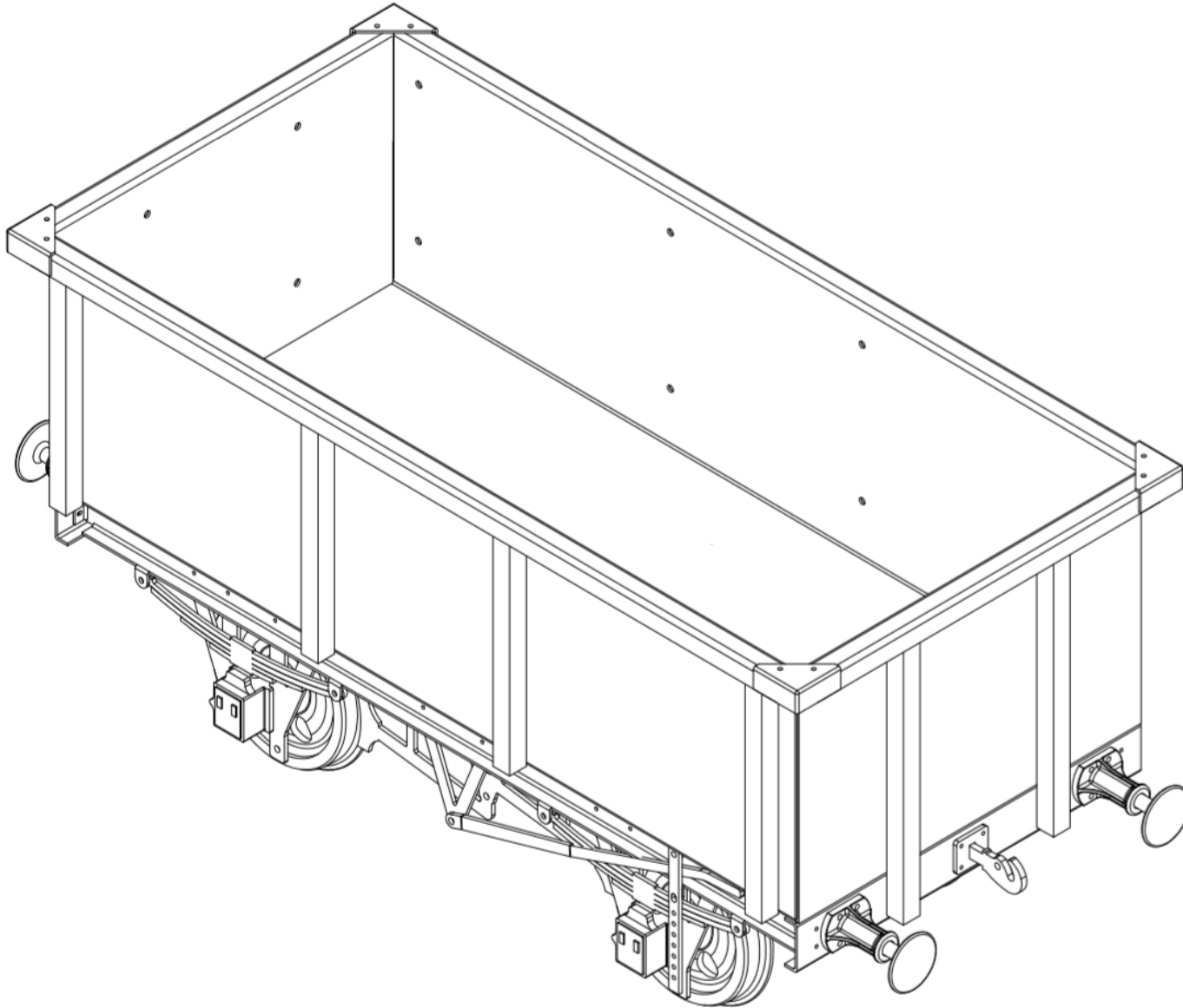
Tippler and Sand Wagons

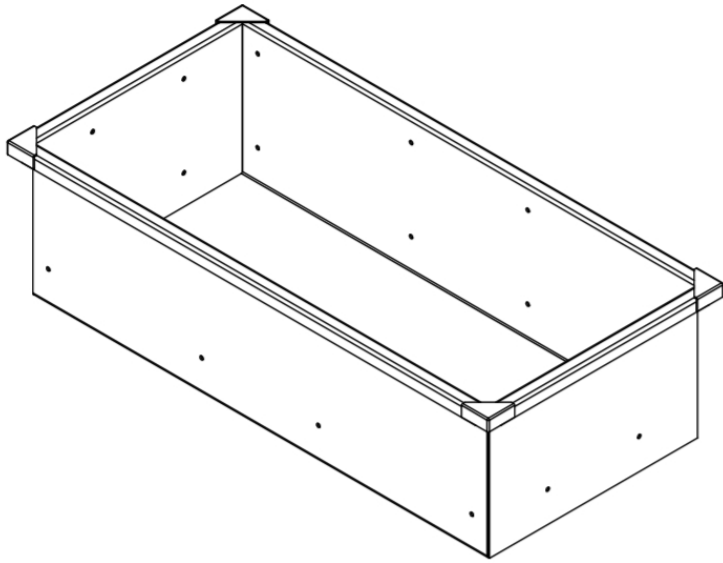

Tippler and Sand Wagons



1x
Welded Together
Body



8x
Short Stanchions

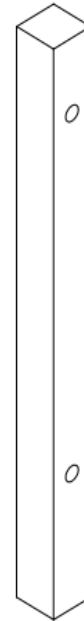

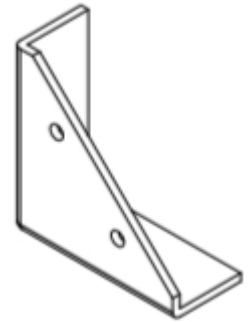

4x
Long Stanchions



4x
Folded Corners

Drill out holes and
Fit bolts to
Assemble to
chassis

Bolt Together.
3MM x 6MM bolts
recommended.

Bolt Together.
2MM bolts
recommended.

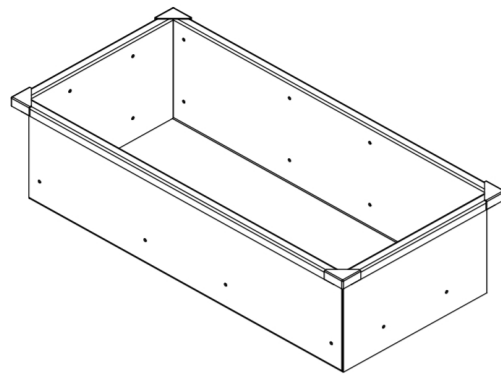

1x
Welded Together
Body



8x
Short Stanchions



4x
Long Stanchions

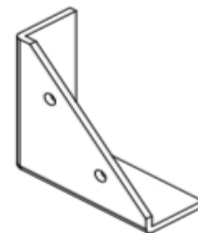

4x
Long Stanchions

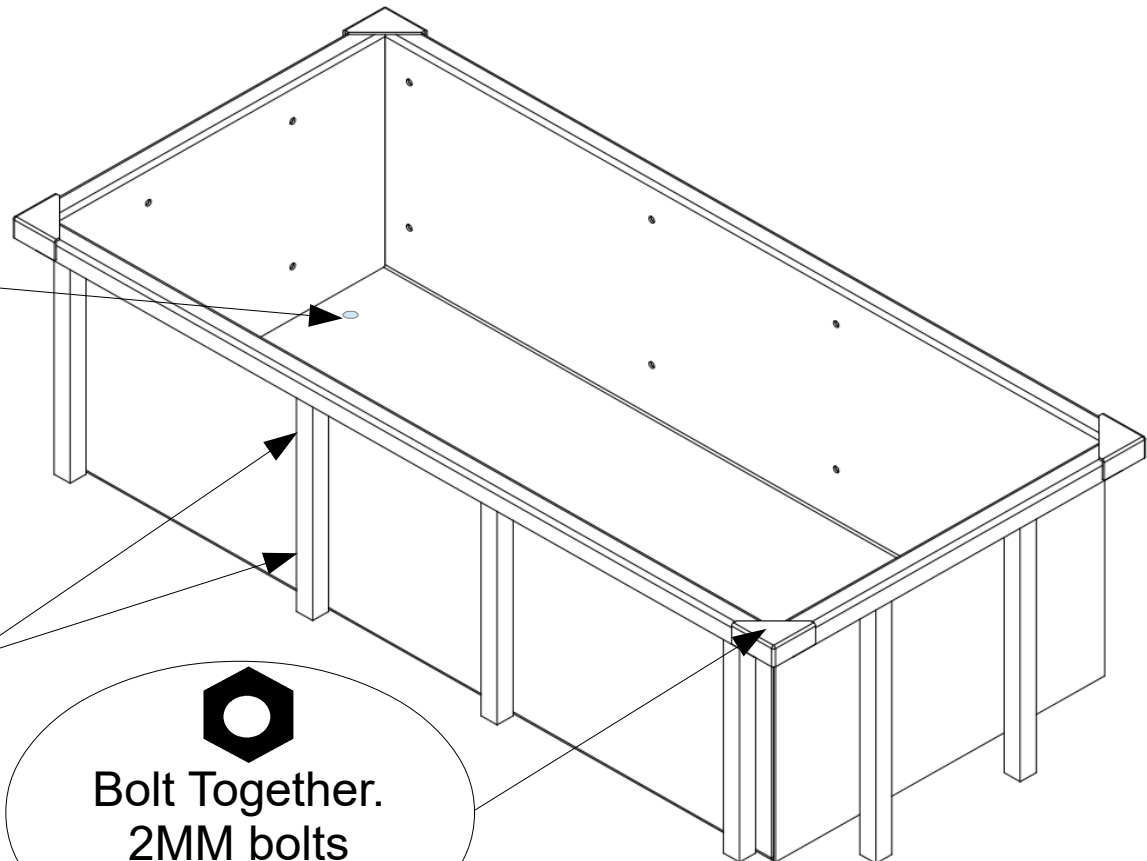

Banana Box Van Kit

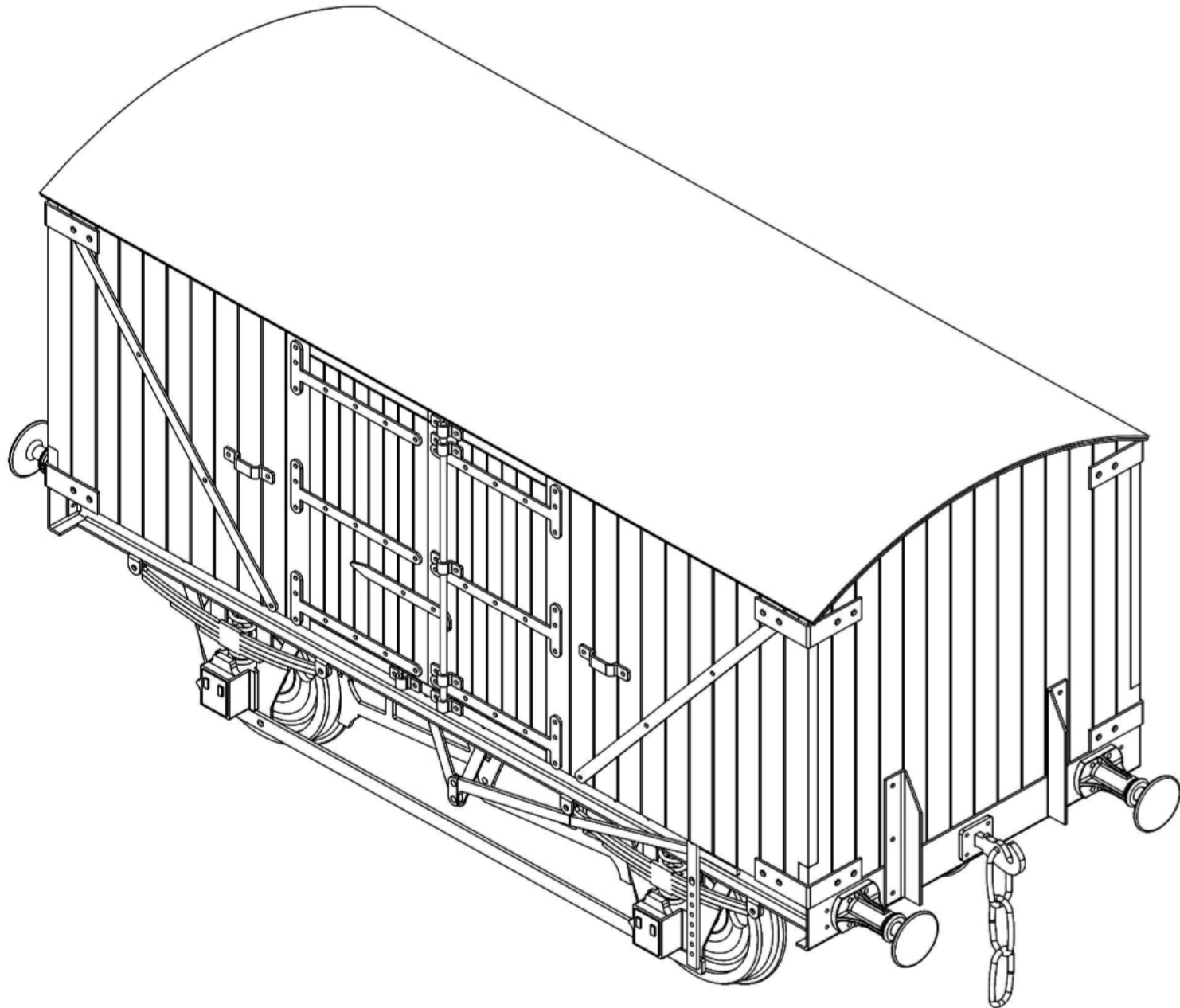

Banana Box Van Kit

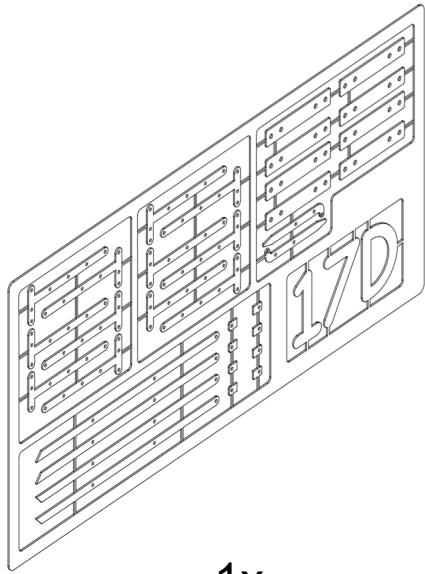

1x
Strapping Fret:
5in Banana Van

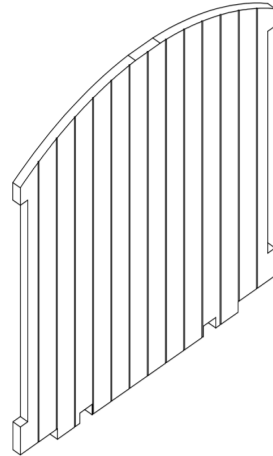

2x
Wooden Ends

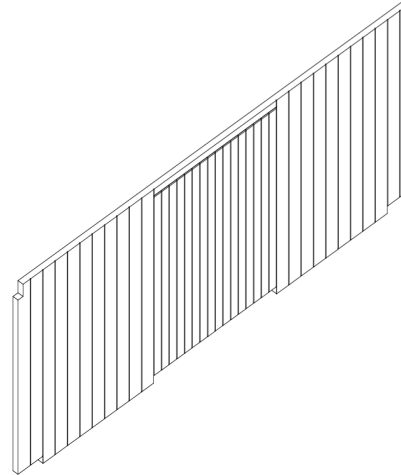

2x
Wooden Sides

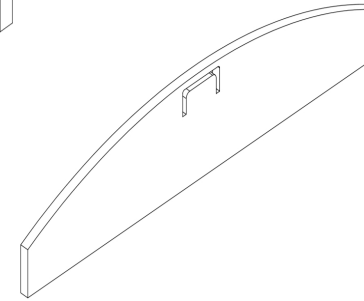

2x
Wooden Roof
inlays

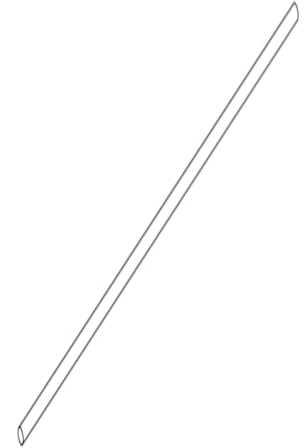

2x
3MM Dia
Door Bars

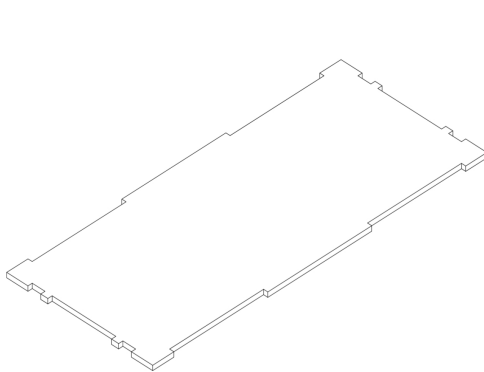

1x
Wooden Base

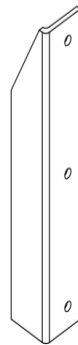

4x
Laser cut and
Folded end pieces

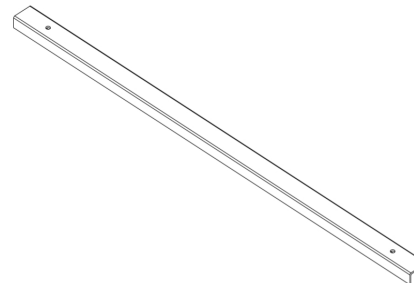

1x
Folded C section

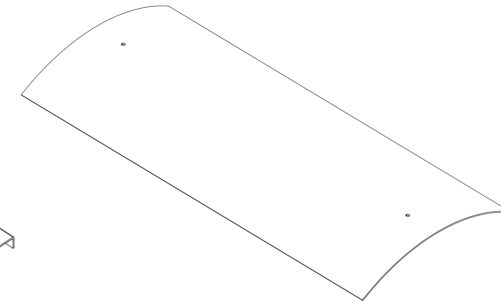

1x
Folded Roof

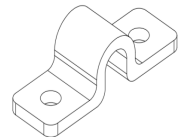

6x
Cast brass
Brackets

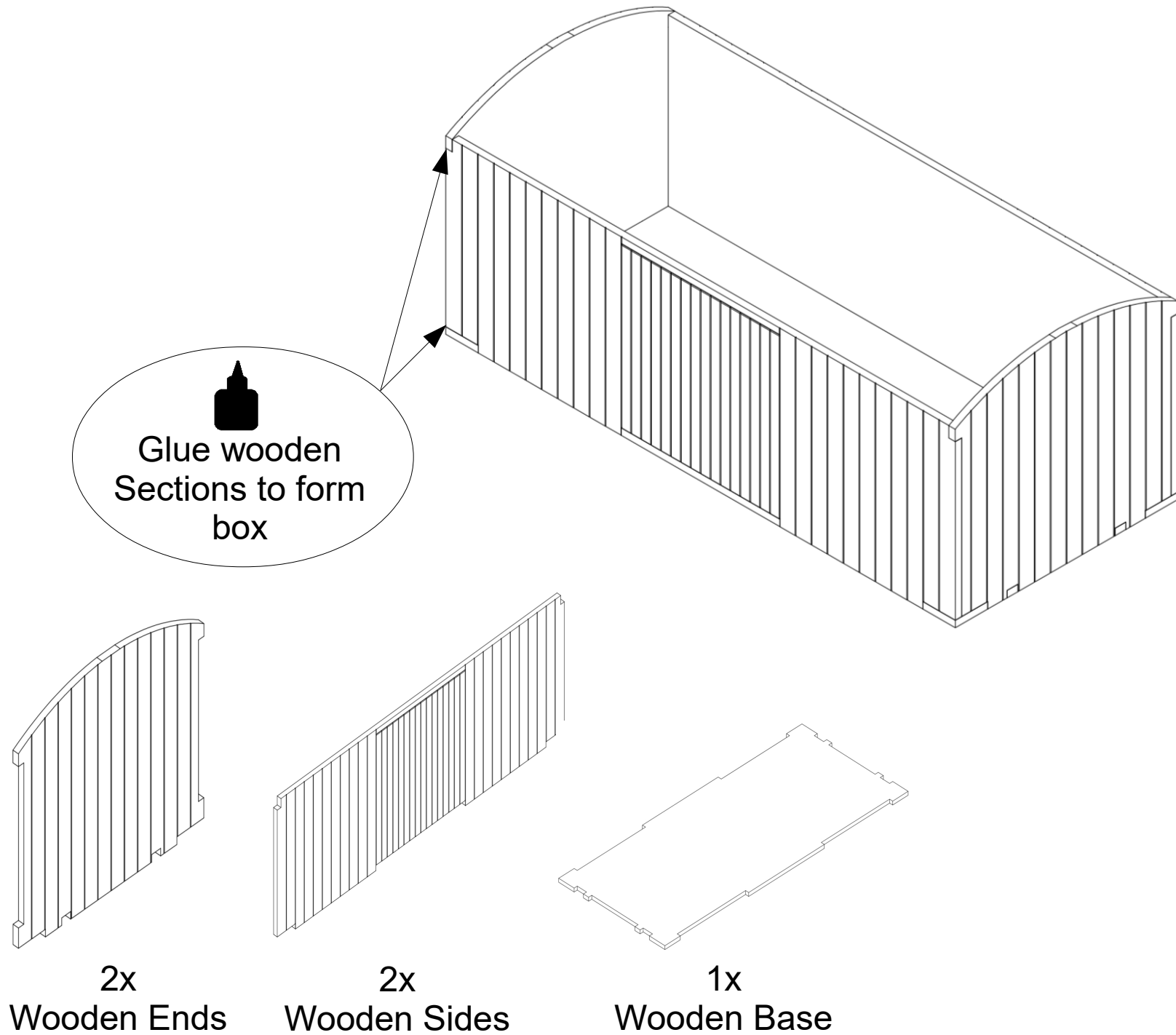

2

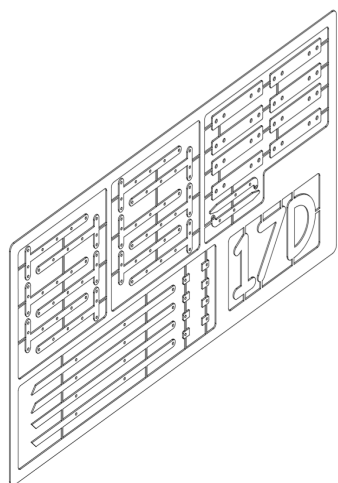
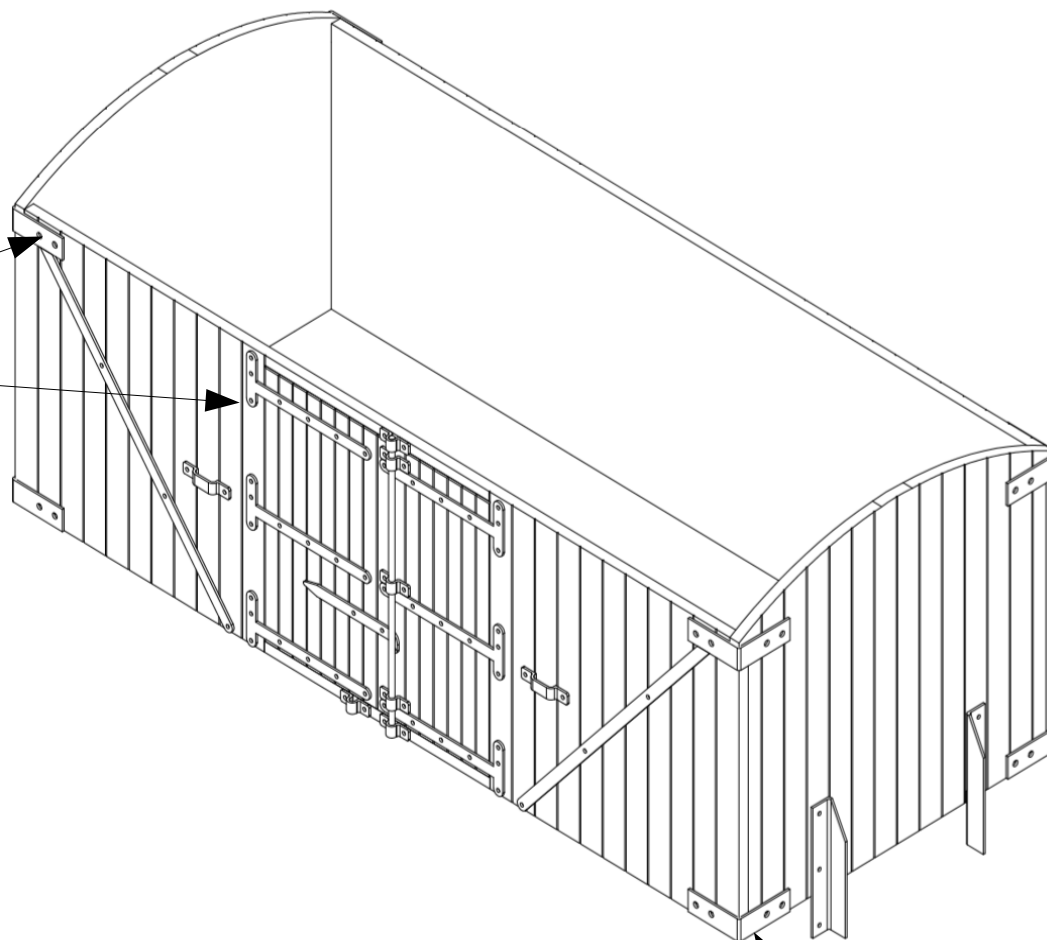
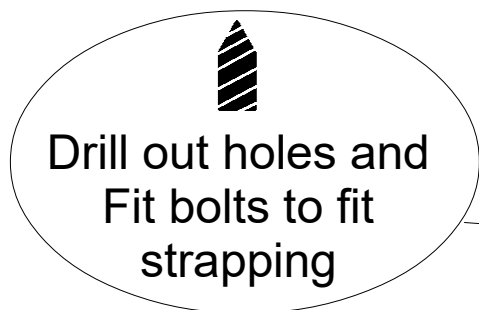

1x
Strapping Fret:
5in Banana Van



4x
Laser cut and
Folded end pieces

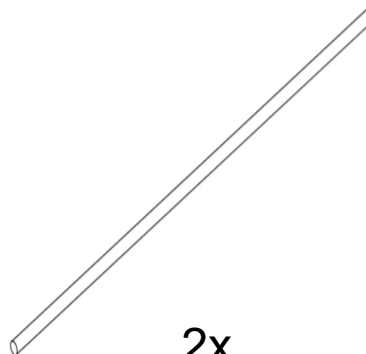

2x
3MM Dia
Door Bars

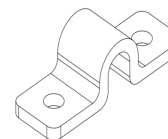

6x
Cast brass
Brackets

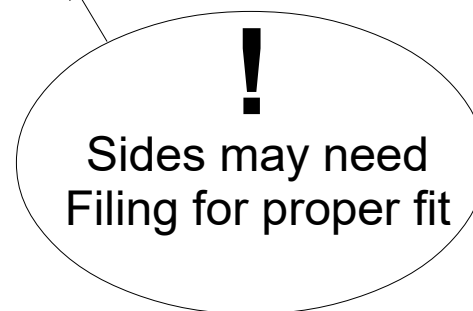

3



First glue these
3 pieces together as
as an sub-assembly
before glueing it
Inside.



Glue
Assembly inside
Box van

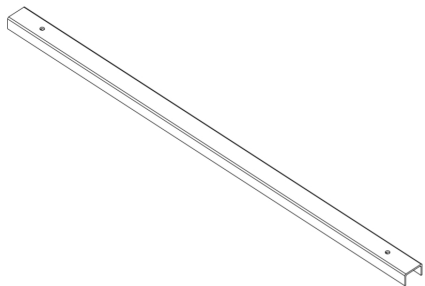
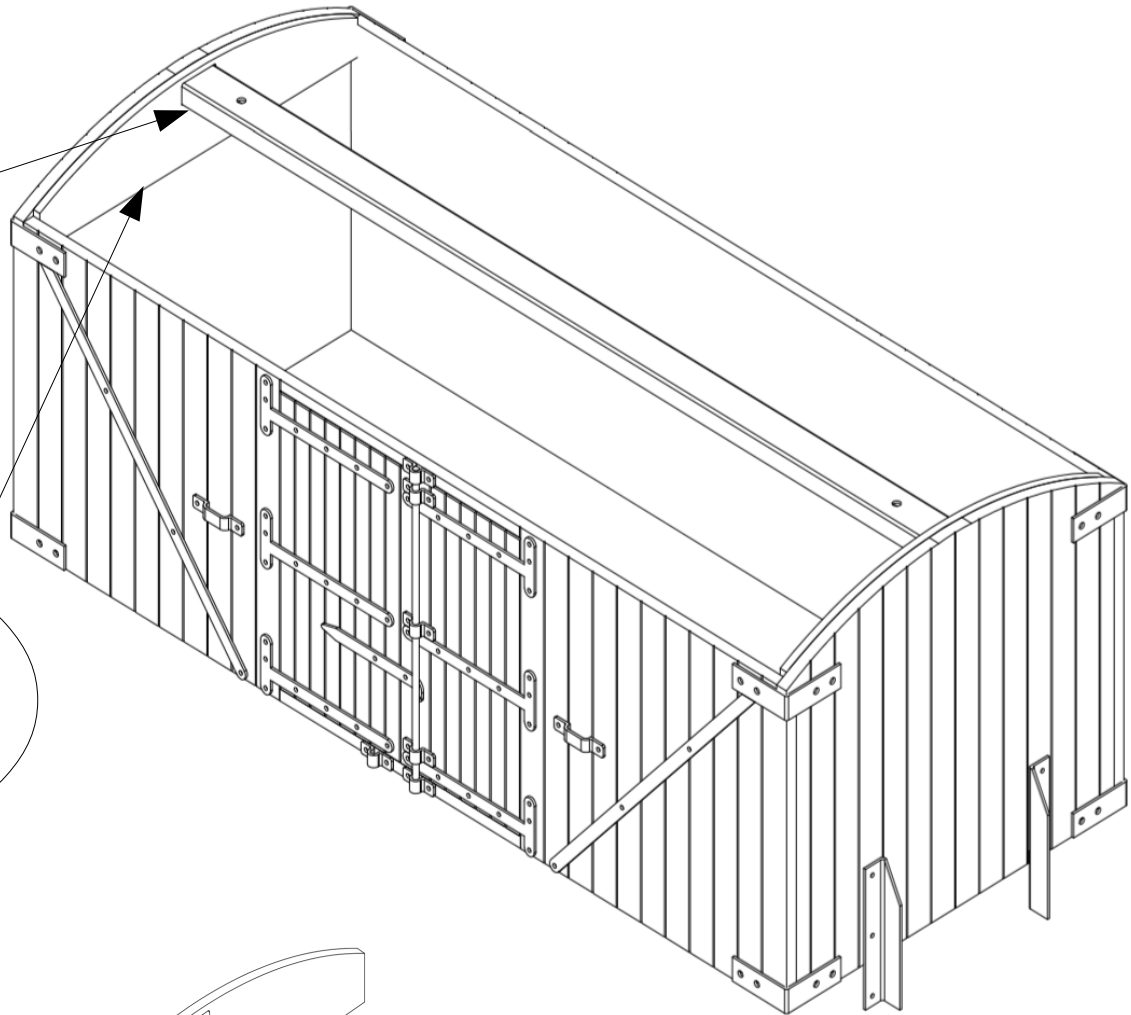

1x
Folded C section

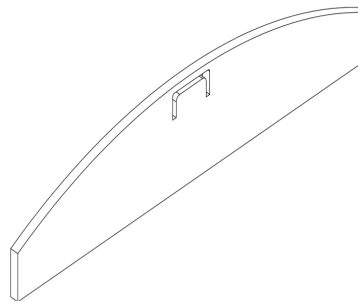

2x
Wooden Roof
inlays

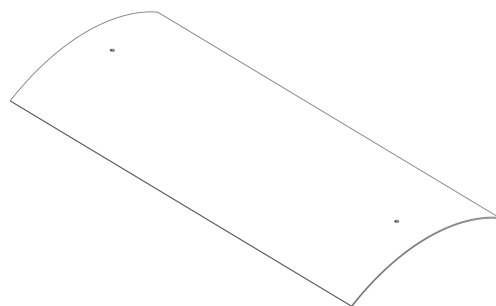

1x
Folded Roof

